



ShawverGroup.com

**Joanna B. Shawver**  
joanna@shawvergroup.com  
816.213.9578

# PROPERTY HIGHLIGHTS

## FORMER BREWERY / RESTAURANT / SHOP

119 Armour Road, North Kansas City, MO 64116

### LOCATION

119 Armour Road  
North Kansas City, MO 64116

### AVAILABLE

**±8,500 SF** Building  
Covered patio with open-air event space  
Street parking with evening parking to the east

### RATES

Available Upon Request

### AREA BUSINESSES

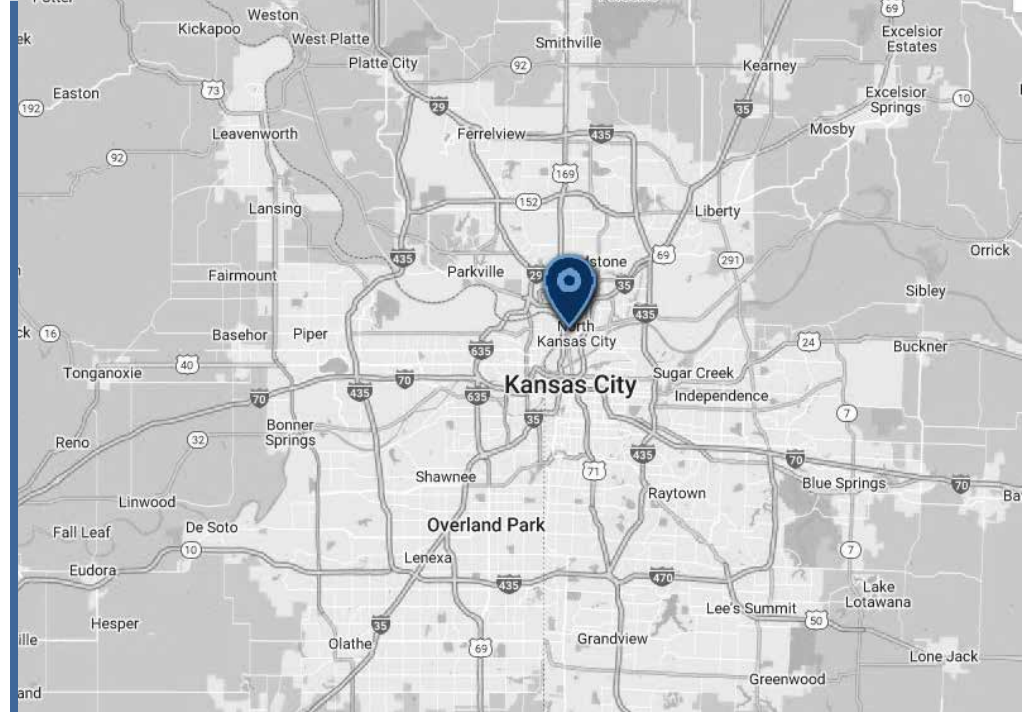

### PROPERTY HIGHLIGHTS

- Located in the heart of North Kansas City
- Walking distance to over ±550 new apartments
- A 5-minute drive to downtown Kansas City
- No earnings tax for businesses

**SHAWVER GROUP**  
COMMERCIAL REAL ESTATE

**Joanna B. Shawver**  
joanna@shawvergroup.com  
816.213.9578

WIDE  
AERIAL

# FORMER BREWERY / RESTAURANT / SHOP

119 Armour Road, North Kansas City, MO 64116

Joanna B. Shawver  
joanna@shawvergroup.com  
816.213.9578

**SHAWVER  
GROUP**  
COMMERCIAL REAL ESTATE

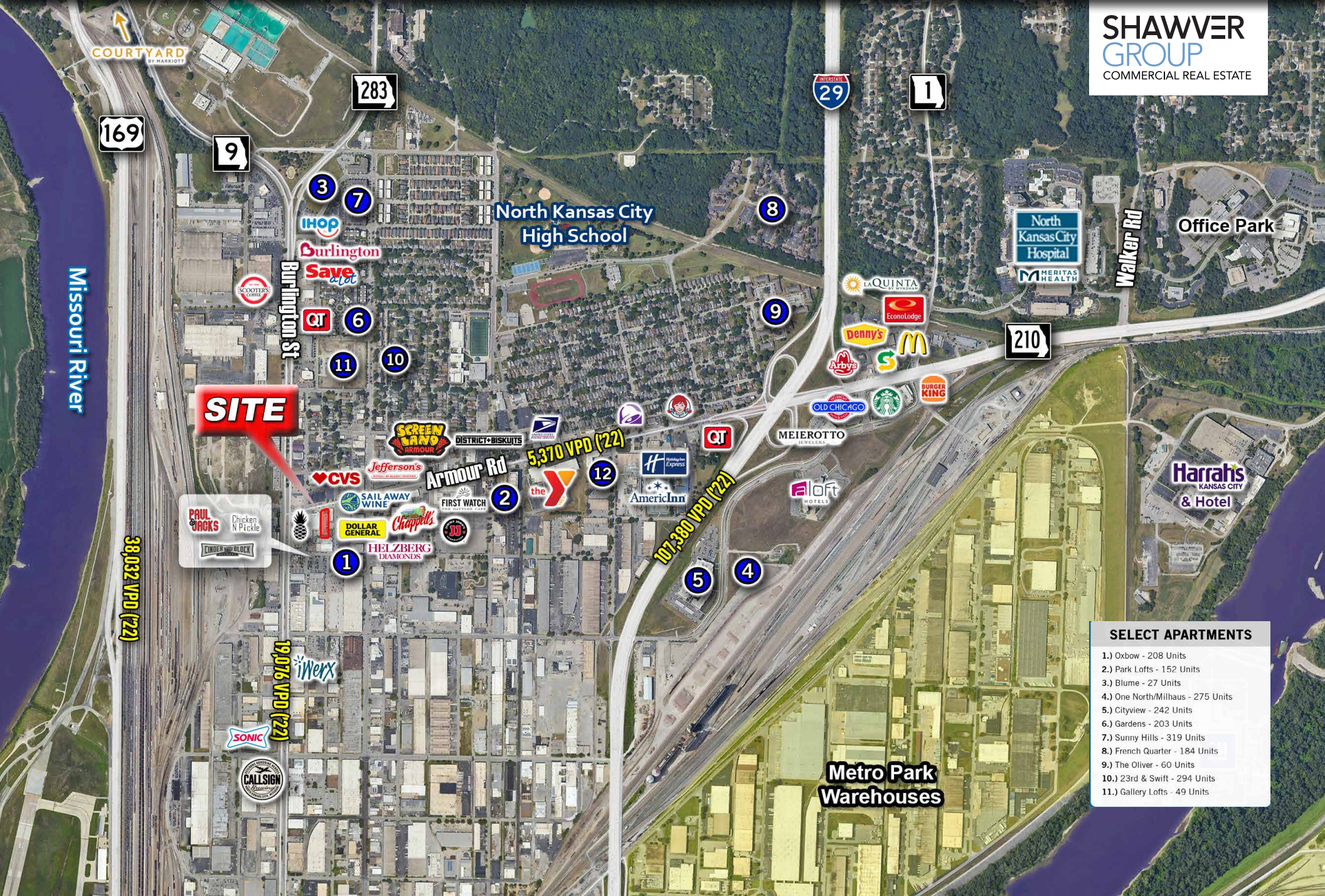

SELECT APARTMENTS	
1.)	Oxbow - 208 Units
2.)	Park Lofts - 152 Units
3.)	Blume - 27 Units
4.)	One North/Milhaus - 275 Units
5.)	Cityview - 242 Units
6.)	Gardens - 203 Units
7.)	Sunny Hills - 319 Units
8.)	French Quarter - 184 Units
9.)	The Oliver - 60 Units
10.)	23rd & Swift - 294 Units
11.)	Gallery Lofts - 49 Units

# SITE AERIAL & DEMOS

## FORMER BREWERY / RESTAURANT / SHOP

119 Armour Road, North Kansas City, MO 64116

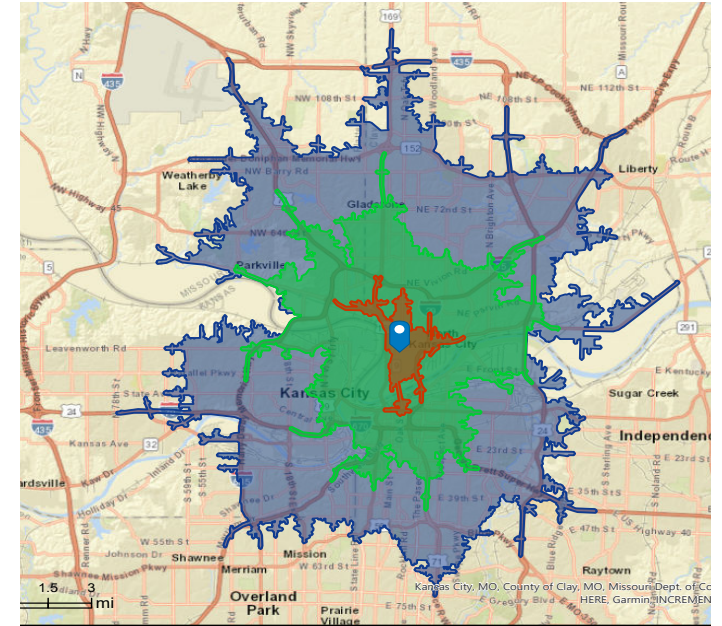

### DEMOGRAPHICS

	5-Minute Drive Time	10-Minute Drive Time	15-Minute Drive Time
Population	8,918	133,744	455,676
Households	4,947	60,135	194,045
AVG HH Income	\$78,087	\$80,329	\$81,403
Median Age	38.7	36.2	36.2

**SHAWVER**  
**GROUP**  
COMMERCIAL REAL ESTATE

**Joanna B. Shawver**  
joanna@shawvergroup.com  
816.213.9578

# SITE PLAN

# FORMER BREWERY / RESTAURANT / SHOP

119 Armour Road, North Kansas City, MO

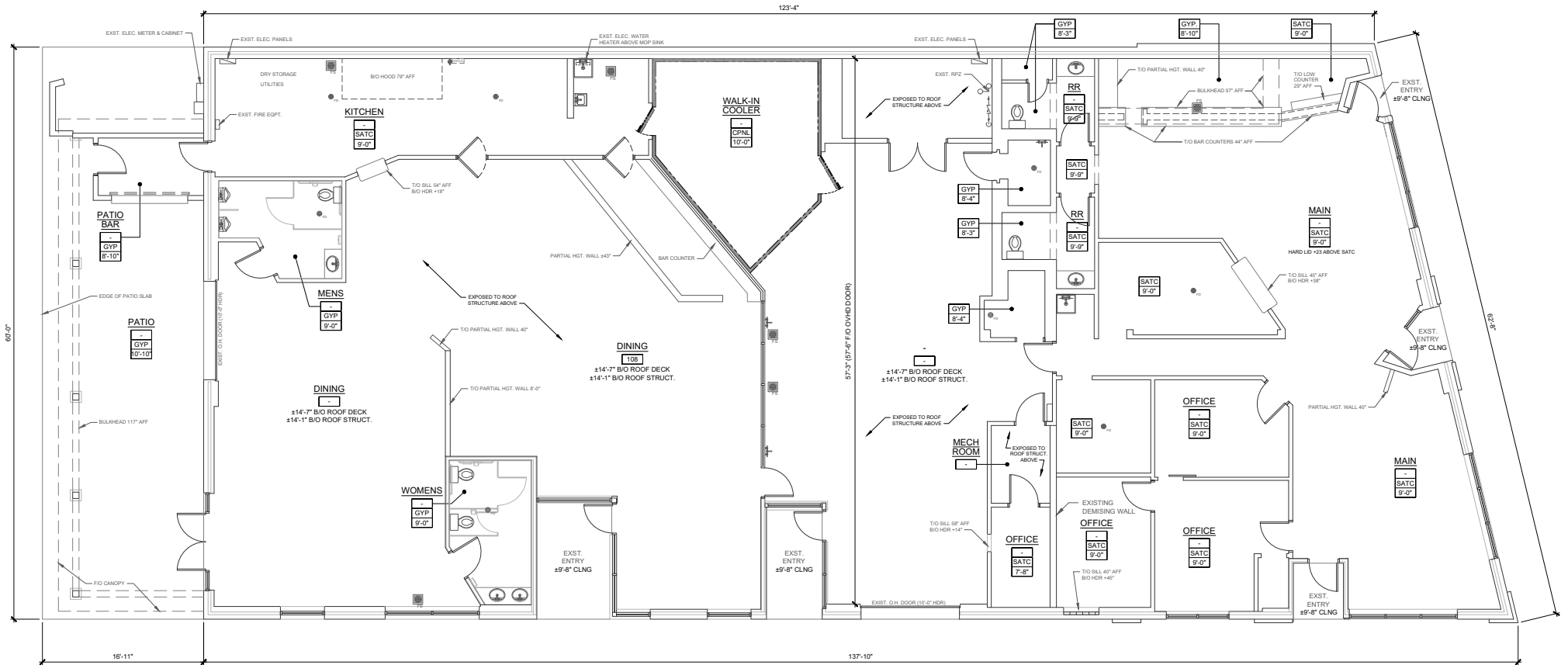

- BUILDING (INCL. PATIO BAR) = ±7,917 SQ.FT.
- INCL. COVERED PORCH = ±8,505 SQ.FT.

# SITE PHOTOS

## FORMER BREWERY / RESTAURANT / SHOP

119 Armour Road, North Kansas City, MO

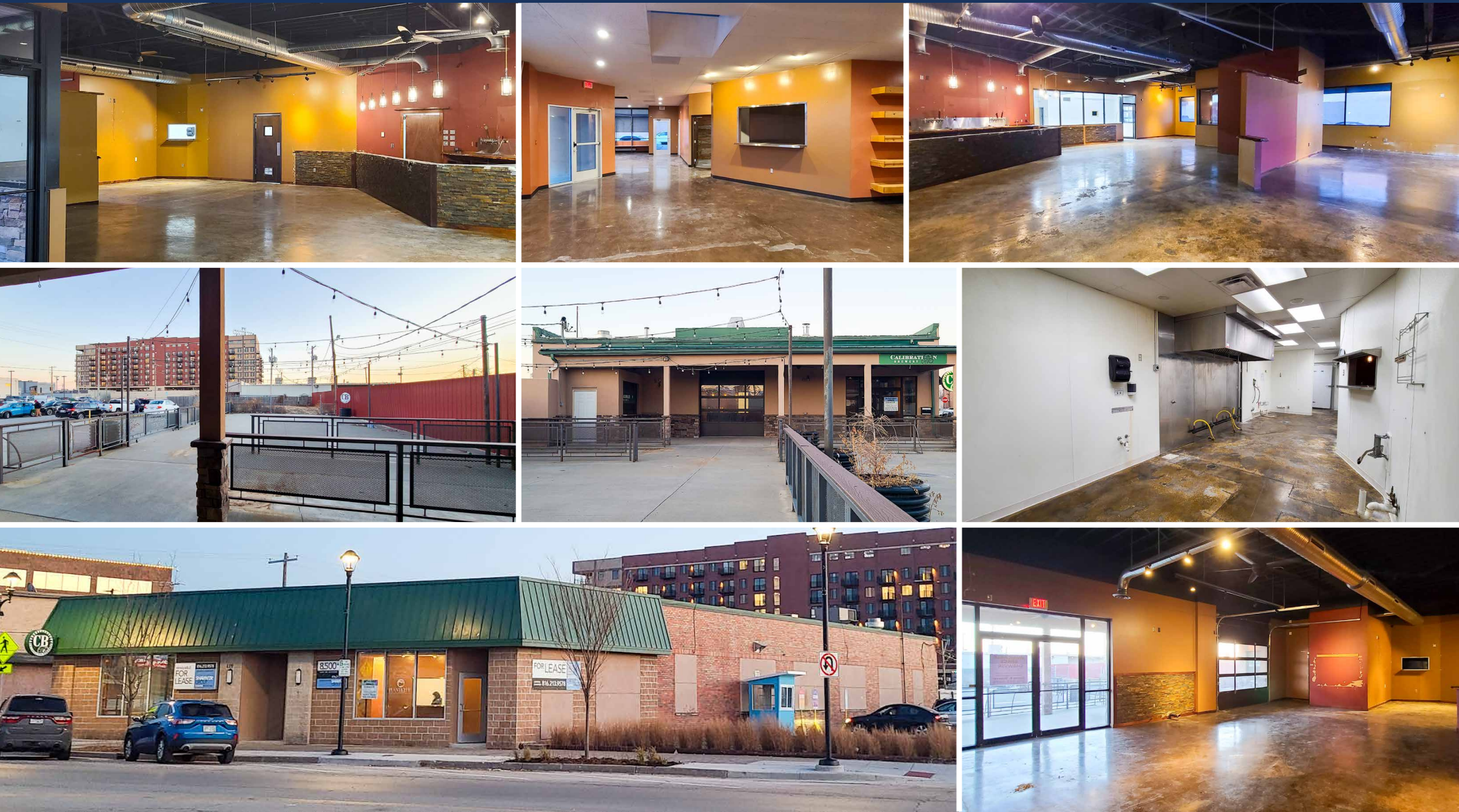

**SHAWVER**  
**GROUP**  
COMMERCIAL REAL ESTATE

**Joanna B. Shawver**  
joanna@shawvergroup.com  
816.213.9578

Disclaimer: All marketing information is deemed reliable but its accuracy is not guaranteed. Neither listing broker(s) or information provider(s) shall be responsible for typographical errors, misinformation, misprints and shall be held totally harmless. Listing information is provided for consumers, personal, non-commercial use and may not be used for any purpose other than to identify prospective tenants who may be interested in leasing or purchasing the property. Any reliance on this information is solely at your own risk.